



Drawing:  
2.5 oz Sloped Oval 24/410

Stock Code:  
002501310240000

Manufacturing Process:  
Extrusion Blow Molding

Overflow Capacity:  
75 - 84 ml (2.55 - 2.85 oz)

Gram Weight:  
10 ± 1.0

Neck Finish:  
24/410

Base Width (A) Base Depth (C):  
1.800 ± 0.050 1.250 ± 0.050

Overall Height (B):  
3.920 ± 0.050

Max Print Area (Height):  
2.610"

Max Print Area (Width):  
1.120"/0.745"

Case Pack: 784

Case Weight (lb): 19.4 ± 1.7

Cases Per Pallet: 25

Box Dimensions:  
23 5/8 x 15 9/16 x 17

Stock Material:



**CLASSIC CONTAINERS INC**  
1700 S. Hellman Ave.  
Ontario, CA 91761  
Phone: 909-930-3610  
e-mail: info@classiccontainers.com  
www.classiccontainers.com



### FRONT VIEW

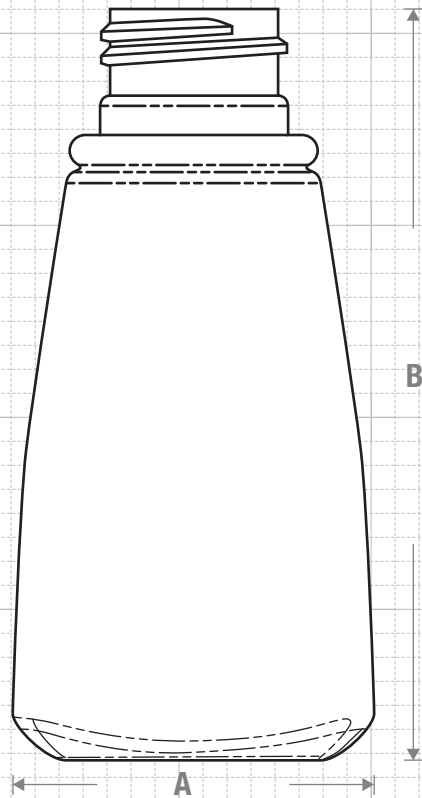

### NECK & THREAD DETAIL

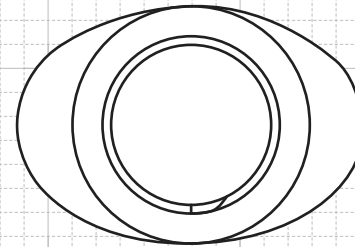
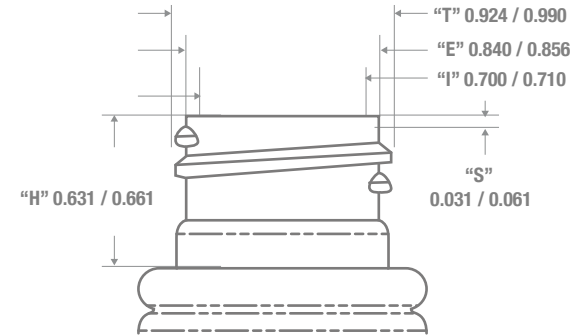

### TOP VIEW

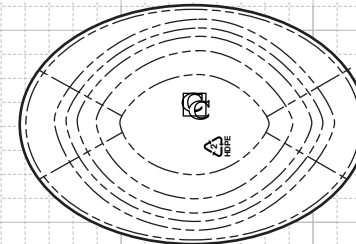

### BOTTOM VIEW

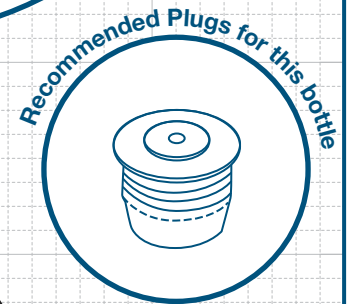

### FRICITION FIT

# PRINTING SPECIFICATIONS: 2.5 Oz Sloped Oval 24/410

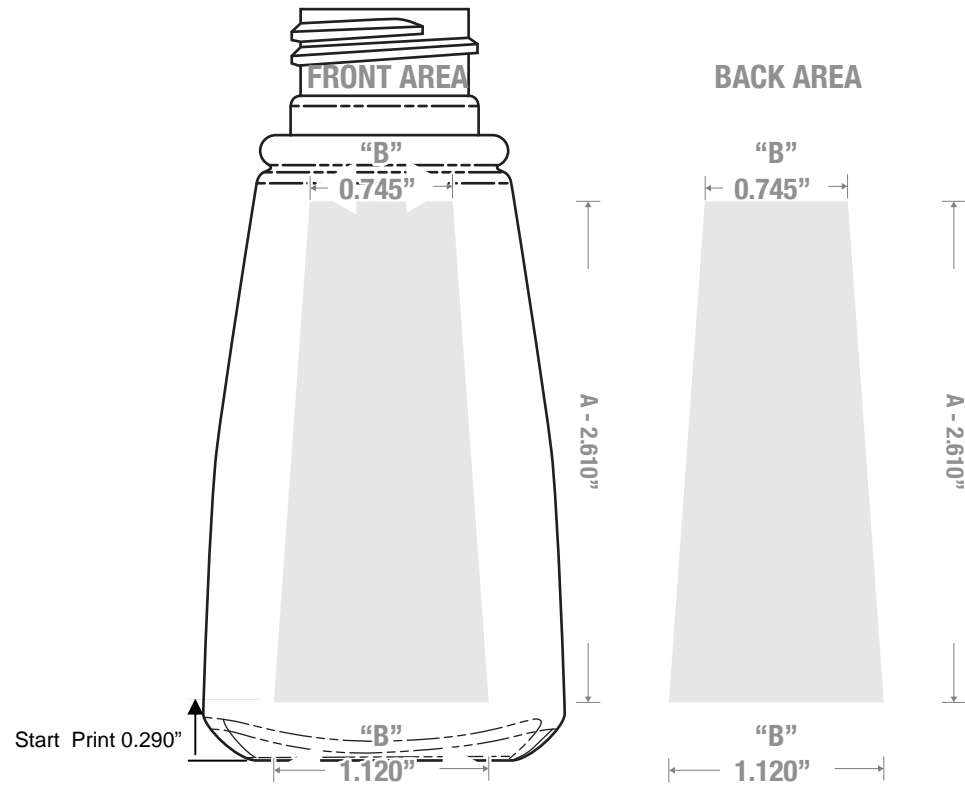

1700 S Hellman Ave, Ontario, California 91761  
Phone: (909) 930-3610 | Fax: (909) 930-3640  
e-mail: [info@classiccontainers.com](mailto:info@classiccontainers.com)  
[www.classiccontainers.com](http://www.classiccontainers.com)

**A - Total Height.**  
**B - Max. Decorating Area.**